



# LAKES PRECISION<sup>INC.</sup>

*Your Global Source for Wire Processing Perishable Tooling*

## ZOLLER & FROHLICH MACHINE SERIES

*THIS SECTION CONTAINS BLADES FOR ZOLLER & FROHLICH AL01 / AL04 MACHINE SERIES*

**Your Global Source for Wire Processing Perishable Tooling**

[www.lakesprecision.com](http://www.lakesprecision.com)

## UNIVERSAL CUT / STRIP BLADES

The sharp edge is ground at an angle that results in a “V” opening of exactly 90 degrees.

Characteristics: 90 degree angle is widely accepted as the best entry angle to use for processing a wide range of wire sizes using the same blade setup. Most of the time, this class of blade incorporates a sharp edge ground to a very small or non-existing radius. It works sufficiently for most of standard wall insulation but is marginal for thin wall, cross-linked PVC, very rubbery insulations, woven fiber or thin-walled multi-conductors.

- TC Coating Available -

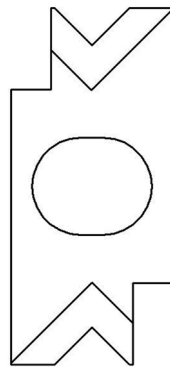

123167

ITEM NUMBER	DESCRIPTION
123167	UN-V CUT / STRIP BLADE FOR AL01

## UNI-V UNIVERSAL STRIP BLADE

The sharp edge is ground to an arc that has a small radius. The entry angle lines meet the arc at a tangent point. Unique to this form is an auxiliary angle that intersects the entry angle. This results in greater insulation penetration and a better strip. This patented blade type allows wire sizes from 26 awg to 10 awg to be processed using a single set of blades.

- TC Coating Available -

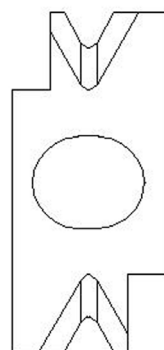

124182

ITEM NUMBER	DESCRIPTION
124182-1	30 DEGREE
124182-2	20 DEGREE

### TRU-RADIUS STRIP BLADE

The sharp edge is ground to a half circle whose radius approximates awg wire size. The entry angle lines intersect the half circle at the quadrant points. This type of blade, when closed, presents a true circle profile.

**Advantages:** This type of blade is excellent for precise and clean jacket removal because it combines the scissor-like shearing action of the by-pass blade with the exact hole profile matching a conductor gauge. Excellent for thin wall cross-link PVC and most rubbery or elastic insulations ( thin or thick wall ).

**Disadvantages:** Shut height cannot be modified to process adjacent wire sizes. Off center wire condition has to be considered when choosing blade size.

- TC Coating Available -

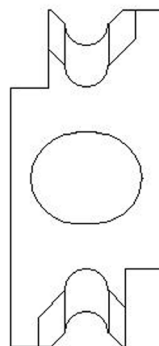

124551

ITEM NUMBER	DIA MM SIZE
124551-1.20	1.20
124551-2.00	2.00
124551-2.40	2.40
124551-3.00	3.00
124551-3.10	3.10
124551-5.75	5.75