



# LAKES PRECISION<sup>INC.</sup>

*Your Global Source for Wire Processing Perishable Tooling*

## NIPPON TANSHI MACHINE SERIES

*THIS SECTION CONTAINS BLADES FOR NIPPON TANSHI STU-2 MACHINE SERIES*

**Your Global Source for Wire Processing Perishable Tooling**

[www.lakesprecision.com](http://www.lakesprecision.com)

# NIPPON TANSHI STU-2 MACHINE SERIES

TRU-RADIUS STRIP BLADES CLASS: TR-V

## TRU-RADIUS STRIP BLADE

The sharp edge is ground to a half circle whose radius approximates awg wire size. The entry angle lines intersect the half circle at the quadrant points. This type of blade, when closed, presents a true circle profile.

**Advantages:** This type of blade is excellent for precise and clean jacket removal because it combines the scissor-like shearing action of the bypass blade with the exact hole profile matching a conductor gauge. Excellent for thin wall cross-link PVC and most rubbery or elastic insulations ( thin or thick wall ).

**Disadvantages:** Shut height cannot be modified to process adjacent wire sizes. Off center wire condition has to be considered when choosing blade size.

- TC Coating Available -

ITEM NUMBER	DIA MM SIZE	DESCRIPTION
122650-039	1.0	STU-2 TR-V STRIP
122650-047	1.2	STU-2 TR-V STRIP
122650-055	1.4	STU-2 TR-V STRIP
122650-067	1.7	STU-2 TR-V STRIP
122650-078	2.0	STU-2 TR-V STRIP
122650-102	2.6	STU-2 TR-V STRIP

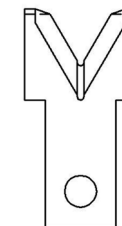

122650-XX

## TANGENT RADIUS “V” STRIP BLADES

The sharp edge is ground to an arc whose radius approximates awg wire size. The entry angle lines meet the arc at a tangent point. This type of blade, when closed, presents a diamond shaped edge profile.

**Advantages:** By adjusting cutter head shut height, ( if insulation material and wall thickness allow ), you can process adjacent wire extrusions.

**Disadvantages:** Inadequate for processing thin wall and/or hard insulations such as cross-link or fiberglass jackets.

- TC Coating Available -

MM SIZE	ITEM NUMBER	OEM #	DESCRIPTION
0.65	123660-051	-----	TA-V STRIP
0.75	123660-059	-----	TA-V STRIP
1.8	123660-072	KD489007-8	TA-V STRIP



123660-XX

# NIPPON TANSHI STU-2 MACHINE SERIES

UNIVERSAL CUT-OFF BLADES CLASS: UN-V



## UNIVERSAL CUT-OFF BLADES

The sharp edge is ground to a radius size. The entry angle lines meet the radius at a tangent point. This type of blade, when closed, presents a diamond shaped edge profile.

Characteristics: Sharp edges cut by slicing, creating a gradual cut. This produces less deformation of the material being cut. Cutting edges must be able to by-pass each other. This type cut-off is best used with circular shaped wire.

ONE 122648 & ONE 122649 EQUALS A BLADE PAIR

- TC Coating Available -

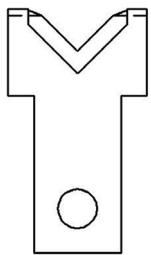

122648

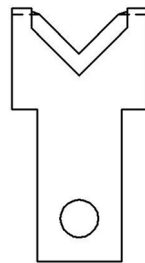

122649

ITEM NUMBER	OEM #	DESCRIPTION
122648	KD490019-1	UPPER CUT-OFF
122649	KD490019-2	LOWER CUT-OFF